

Made with Mapsofuk 2022  
 as to their quality of choice can be given.  
 prospective purchaser. The service, systems and appliances shown have not been based on guarantee  
 omission or misstatement. This plan is illustrative purposes only and should be used as such by any  
 of door, window, count and any other items are approximate and on responsibility taken for any error.  
 While every attempt has been made to ensure the accuracy of the floor plan, measurements  
 TOTAL FLOOR AREA: 115.4 sq.m. (1242 sq.ft.) approx.

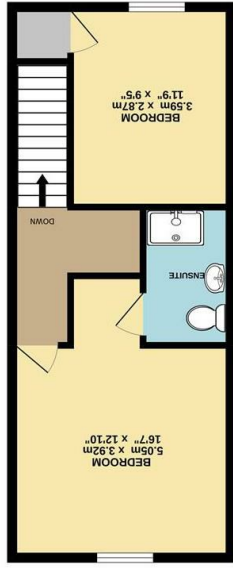
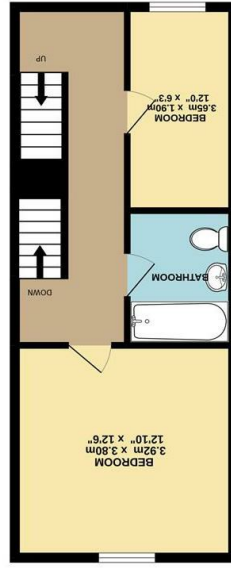
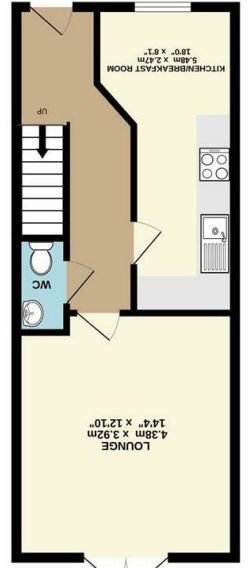

GROUND FLOOR  
 38.6 sq.m. (419 sq.ft.) approx.

1ST FLOOR  
 38.1 sq.m. (410 sq.ft.) approx.

2ND FLOOR  
 38.6 sq.m. (419 sq.ft.) approx.

Energy Efficiency Rating	
Potential	93
Current	81
England & Wales EU Directive 2002/91/EC Not energy efficient - higher running costs Very energy efficient - lower running costs	
A	(92 plus)
B	(81-91)
C	(69-80)
D	(55-68)
E	(39-54)
F	(21-38)
G	(1-20)

Disclaimer - In accordance with the Property Misdescriptions Act, the company gives notice that all descriptions, references to condition, necessary permissions for use and other details are given in good faith and believed to be correct, but any intending lessees do not rely on them as statements of fact, but must satisfy themselves by inspection or other means, as to their accuracy.



Norfolk Property  
 online.

Ron Hill Road | Norwich | NR8  
 £280,000

**Norfolk Property  
online.**

Norfolk Property online presents this stylish, modern townhouse. Located in the popular residential area of Costessey, this home has been exceptionally well-maintained and offers a flexible layout over three floors. The ground floor offers an inviting entrance hall, cloakroom, lounge and kitchen breakfast room. The first floor offers two bedrooms and a family bathroom, with the top floor offering two further double bedrooms and an en-suite shower room. Externally, the rear garden offers a high degree of privacy. Offered to the market with no onward chain, an internal viewing comes highly recommended.

